

● Project Update

The Project Team completed Virtual Design Charrettes Session #2 with all user groups in late January, focusing on planning fixtures, furniture, and equipment (FFE) for each space. With this foundation in place, the design team is now working on the mechanical and electrical systems to support the new addition, ensuring they align with end-user needs and devices.

The next and final Design Charrette will involve a detailed review of department layouts, room-specific designs, and FFE placements, incorporating input from all user groups. While designs will continue to evolve, collaboration among multiple disciplines—along with patient perspectives—has resulted in efficient, intentional, and thoughtfully designed spaces.

Additionally, interior palettes and exterior facade planning are now underway, bringing us one step closer to a modernized, patient-centered facility.

● TBT: Sydenham Hospital in the 1950's



Article from the Sydenham Current

In recognition of Wallaceburg's 150th anniversary this year, the Wallaceburg & District Museum has launched a new feature on social media: '150 Facts, for 150 Years'.

Here is one of their recent posts:

"The Sydenham Hospital was first conceptualized at the end of the First World War, when a flu like epidemic swept the country killing millions throughout North America. The tragic virus was thought to be brought over with the returning soldiers who fought in Europe. More than fifty deaths were recorded in Wallaceburg alone. Captain James Steinhoff turned over the Arlington Hotel to use as an emergency hospital, but the community felt it needed a permanent health institution after the Spanish Flu ceased.

Sisters Ada Meredith and Alma Baughman rallied on behalf of the Imperial Order Daughters of the Empire (Baldoon Chapter), leading the movement for the hospital to be situated on land donated by Charles Hazzard. By 1922, over \$35,000 had been raised. Unfortunately, this was not enough, and the idea was shelved for the next 30 years until the Second World War when fresh hope, and the need to house returning injured veterans, saw a renewed desire to build a local hospital.

Exercising his great organizational abilities and with the communities' amazing spirit, H.W. Burgess (a.k.a. "Mr. Wallaceburg") spearheaded the drive to bring the hospital idea into a reality.

Fundraising began in earnest, and the first sod for the new hospital was turned on June 7, 1955 - this time on land donated by Lawrence (Tony) and Emily Martin.

In October of that year, the brand-new Sydenham Hospital opened its doors to patients.

The hospital is a staunch reminder of the strong community spirit in Wallaceburg with the citizens digging deep to fund the first expansion in 1967 when the east wing was added. Since then, many times the community has fought hard to keep the hospital going. Some would say, it is the symbol of hope and dedication of a community that shed blood, sweat, and tears, to provide care for its residents."

● A Night of Comedy

A Night of Comedy

May 10, 2025 7:00 PM

Sydenham Curling Club Wallaceburg

FEATURING THE FABULOUS YUK YUK'S ACTS



Gilson Lubin



Mike Wilmot



Shannon Laverty



Justin Shaw

FOLLOWED BY MUSIC BY THE BLOOZE HOUNDS

Wallaceburg's SOLD OUT A Night of Comedy event in support of the #OurHospitalOurFuture Wallaceburg Site Redevelopment will put on an unforgettable night of laughs, entertainment, food, drinks, dancing and more. The amazing night will feature the comedic stylings of some renowned comedians, including:

- Gilson Lubin
- Mike Wilmot
- Shannon Laverty
- Justin Shaw
- Followed by The Blooze Hounds band!

Didn't get tickets but want to be involved? Here's some great ways to support our community hospital:

- Donate to A Night of Comedy online at: <https://ckhaf.ca/a-night-of-comedy/>. Proceeds to support the Our Hospital, Our Future Wallaceburg site redevelopment project.
- Sponsorship and/or silent auction item donation. Contact John Oliveira at 519-365-1599 or email ANOC05102025@gmail.com for a sponsorship information package. This is a great way to advertise your business!
- Band only portion: Doors are open to the public after 10pm to rock out to The Blooze Hounds band (\$10 cover).
- 50/50 community wide draw; coming soon. Stay tuned for details!

Draft Floor Plan

As Stage 2.2 of Detailed Design Planning progresses, the floor plan continues to evolve and grow. Below is the latest test-fit floor plan based on conversations in the Design Charettes and work with DIALOG's design team.

While the floor plan looks fairly set, the final design may look quite different.

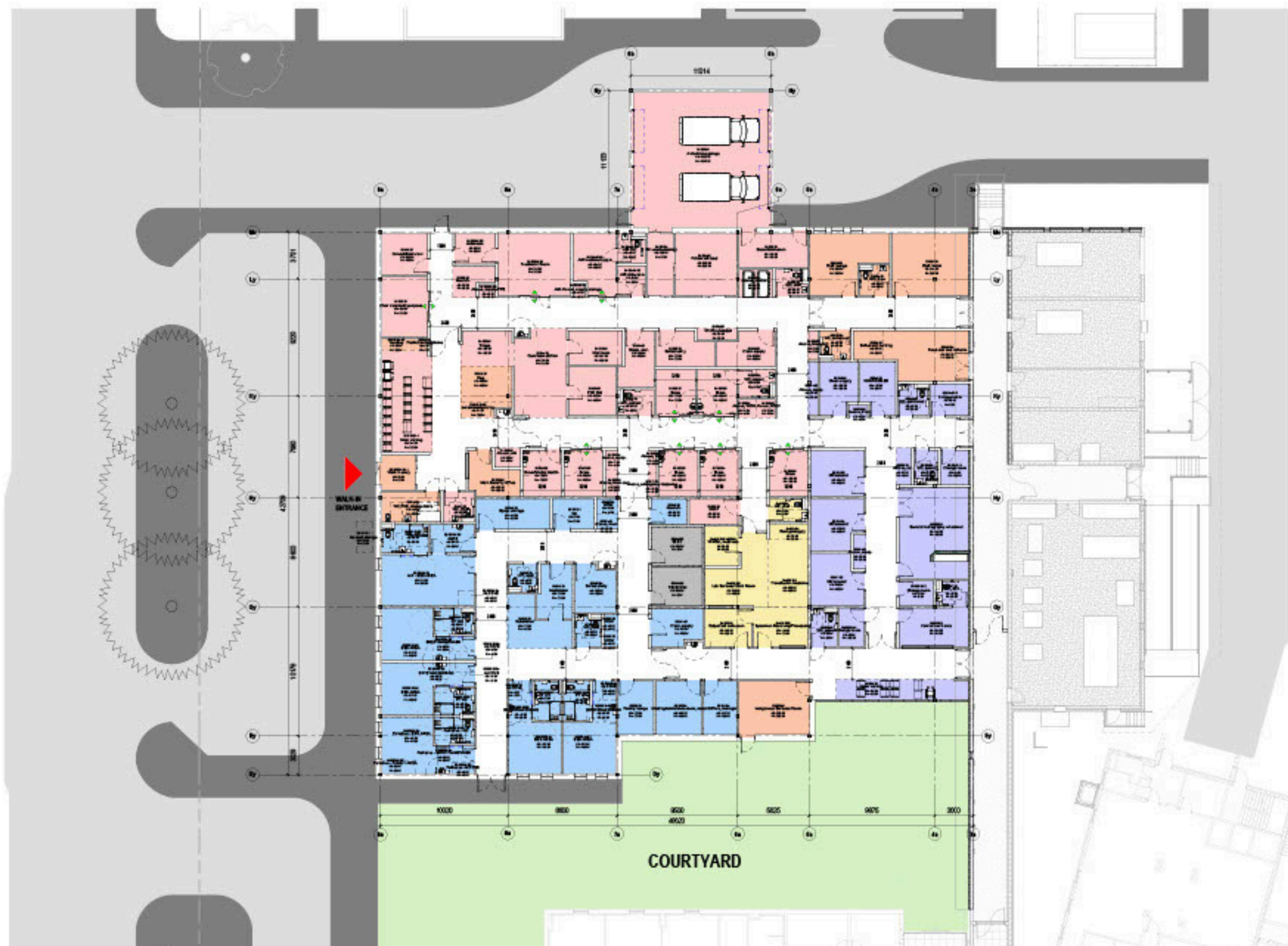

Capital Planning Stages

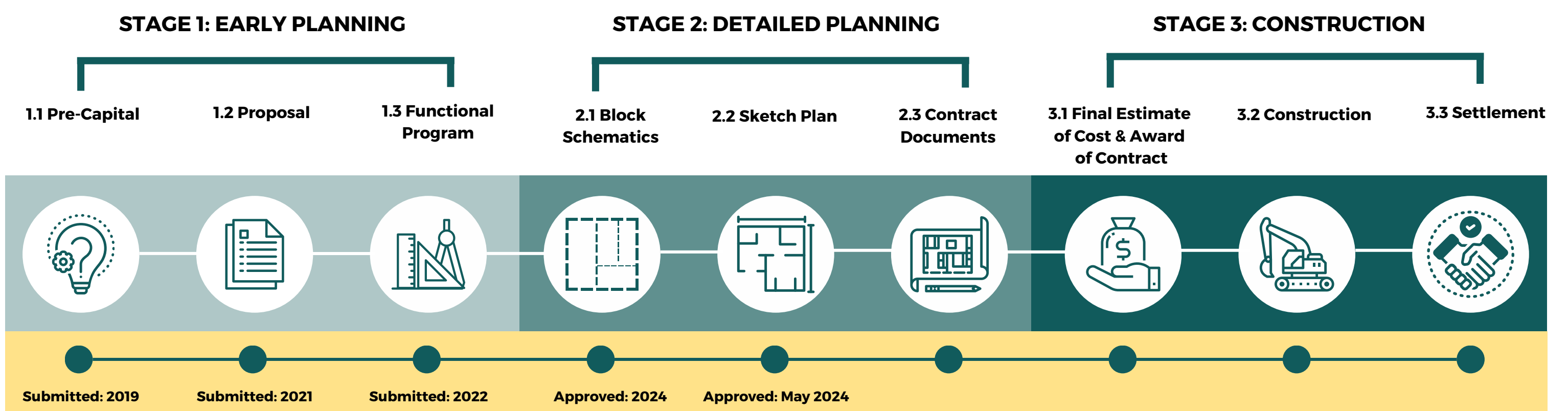

↑
WE ARE HERE

Contact Us

For more information about the Wallaceburg Site Redevelopment Project, please visit our website OurHospitalOurFuture.com or contact us at OurHospitalOurFuture@ckha.on.ca

**OUR HOSPITAL
OUR FUTURE**
WALLACEBURG SITE REDEVELOPMENT